



HORECA  
EQUIPEMENT  
TEL.04/286.12.41  
FAX.04/286.47.26

# EXPOBAR

PAGE 194

1

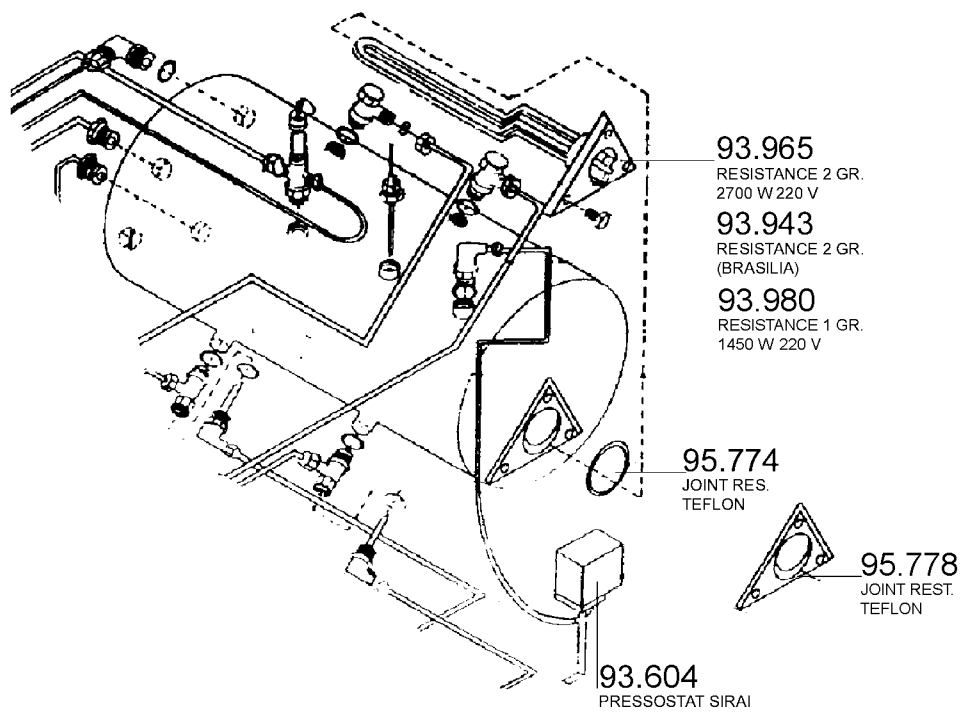
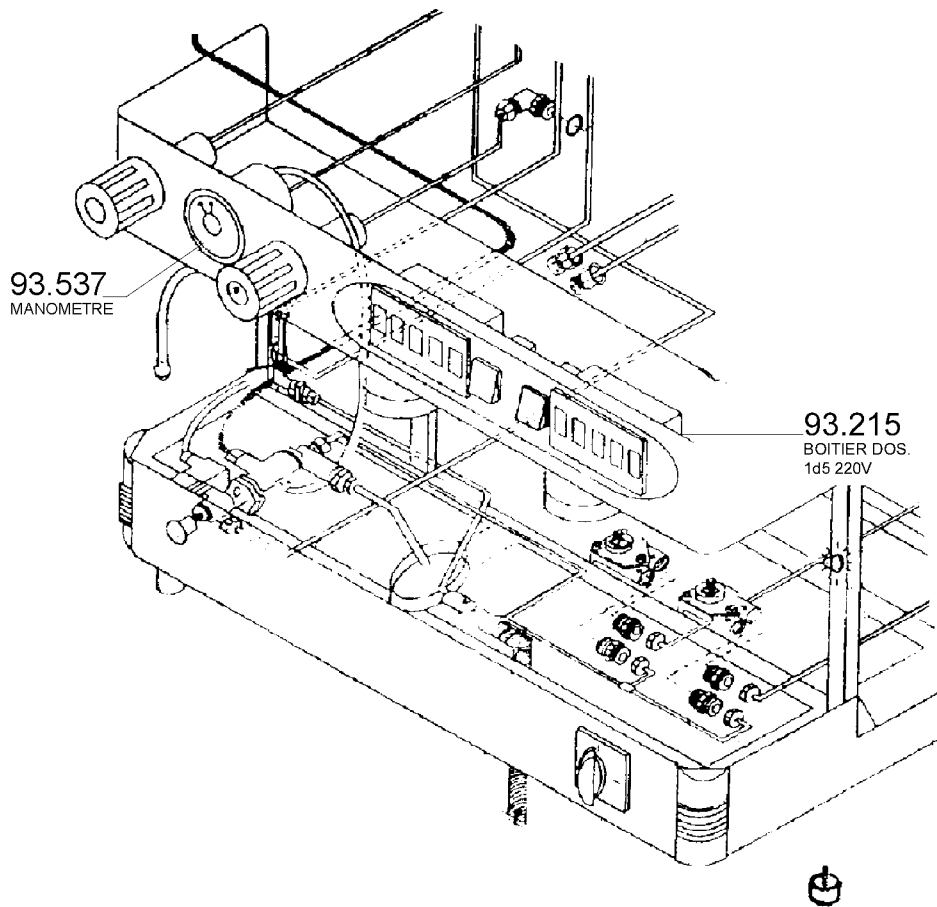



HORECA  
EQUIPEMENT  
TEL.04/286.12.41  
FAX.04/286.47.26

# EXPOBAR

PAGE 194.1

1.1

## CHAUDIERE MONROC

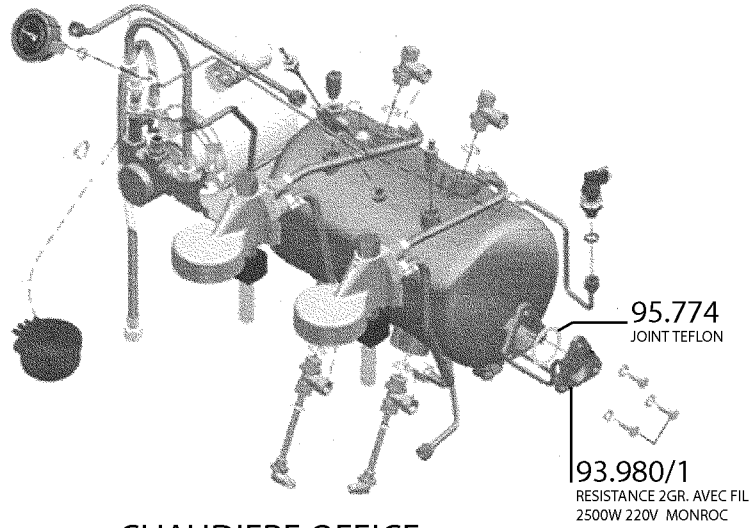

## CHAUDIERE OFFICE

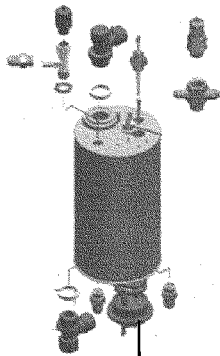

93.965/1  
RESISTANCE 1 GR.  
1200W 220X OFFICE

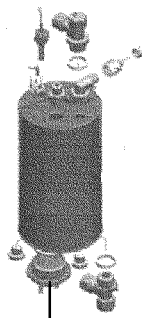

93.965/1  
RESISTANCE 1 GR.  
1200W 220X OFFICE

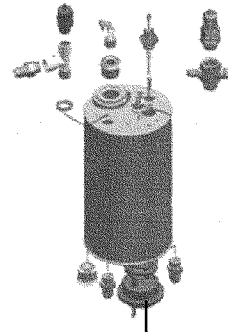

93.965/1  
RESISTANCE 1 GR.  
1200W 220X OFFICE

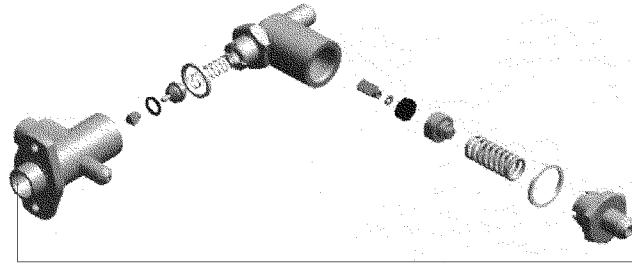

93.341  
ELECTROVANNE  
DE REMPLISSAGE

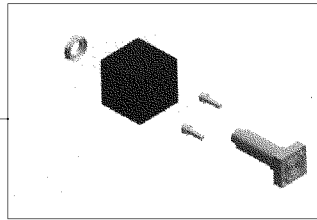

28.006  
ROBINET VAPEUR  
INTER-ELEGANCE

28.007  
ROBINET VAPEUR  
CLASSIC

28.008  
ROBINET EAU COMPLET

28.001  
POMMEAU

28.002  
VOLANT COMPLET EAU

28.003  
VOLANT COMPLET VAPEUR

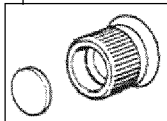

93.797  
NIV. EAU

95.126  
JOINT NIV. EAU

96.304/1  
RONDELLE

40.013  
GOUPILLE FENDUE

28.006  
ROBINET VAPEUR  
INTER-ELEGANCE

28.007  
ROBINET VAPEUR  
CLASSIC

28.008  
ROBINET EAU CHAUDE

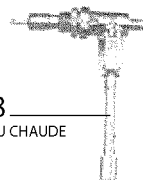
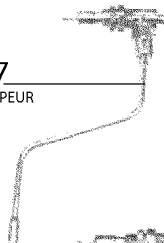
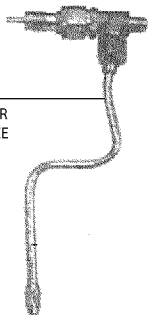

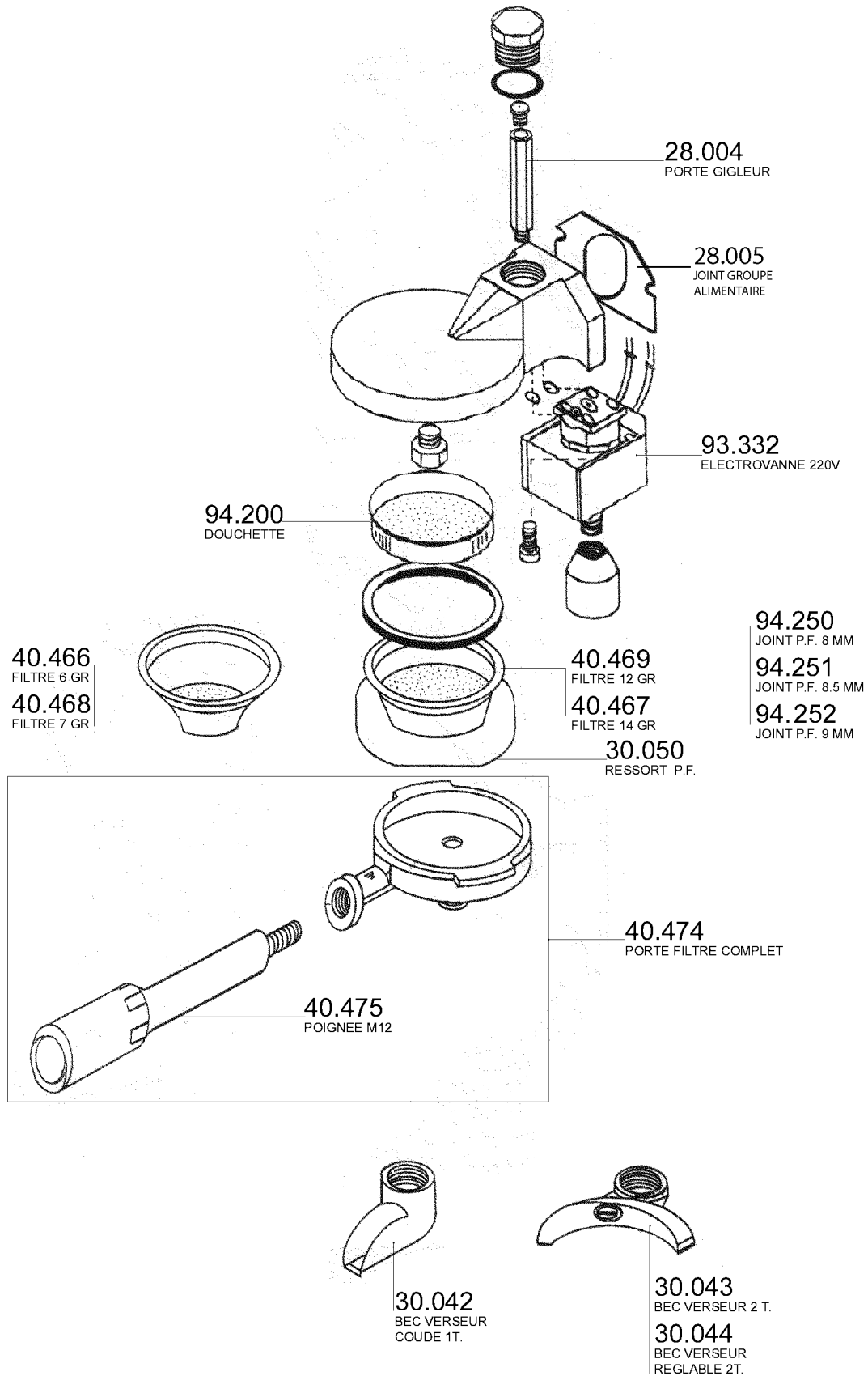



HORECA  
EQUIPEMENT  
TEL.04/286.12.41  
FAX.04/286.47.26

# EXPOBAR

PAGE 196.1

4

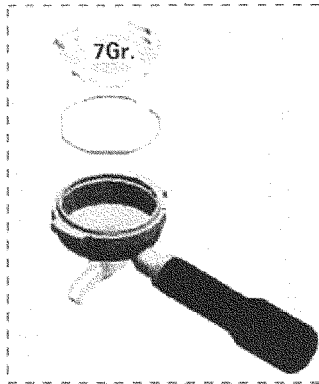

28.009  
PORTE FILTRE COMPLET 1 T

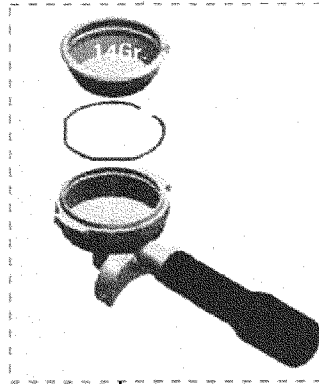

28.010  
PORTE FILTRE COMPLET 2 T

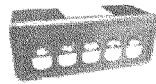

93.215/1  
CLAVIER 3d5  
MEGACREM



**HORECA  
EQUIPEMENT**  
TEL.04/286.12.41  
FAX.04/286.47.26

# EXPOBAR

**PAGE 196.2**

4.1

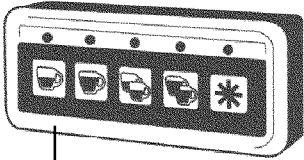

**93.215/2**  
BOITIER GICAR 9.9.09.51G  
MONROC

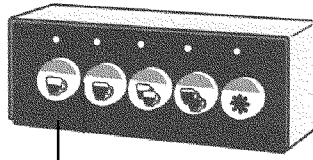

**93.215/3**  
BOITIER GICAR 9.9.07.28G  
MARKUS

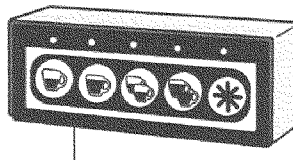

GICAR CODE 9.5.27.60G

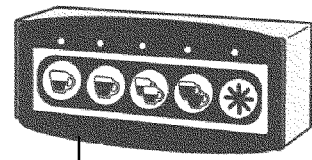

**93.215**  
BOITIER GICAR 9.5.28.30G 00  
NEW ELEGANCE, OFFICE

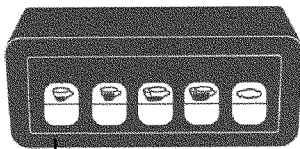

**93.215/4**  
BOITIER GICAR 9.5.28.61G 00  
MONROC

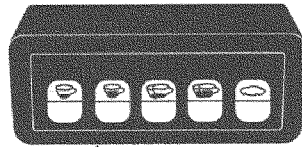

**507033**  
GICAR CODE 9.5.28.59G 00



**507008**  
GICAR CODE 8.9.46.46

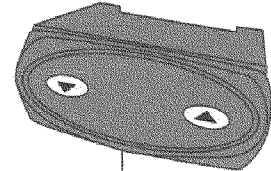

**507030**  
GICAR CODE 9.3.00.43G

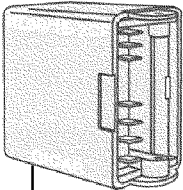

**93.207**  
REG. NIV. EAU  
RL30/1E/2C/F 220V

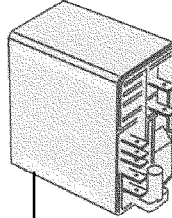

**93.207/2**  
REG. NIV. EAU  
RL01E/SIC/F+LED 240V  
MONROC

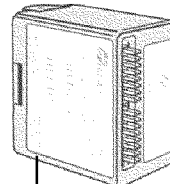

**93.207/3**  
CENTRALE DOSEUR  
ET 30F 2GRC 240V

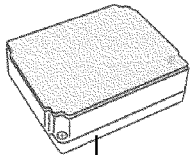

**93.230**  
CENTRALE DOSAGE 1.2.3 LUX  
GICAR 9.5.25.50G01  
MARKUS

**93.230/1**  
CENTRALE DOSAGE 1.2.3 XLC  
GICAR 9.5.32.01G01  
DIAMANT, MONROC, NEW ELEGANCE.

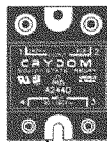

**93.282/1**  
RELAIS STATIQUE  
25A 24/280VAC-3/32VDC

**93.282/2**  
RELAIS STATIQUE  
50A 24/600VAC-3.5/32VDC

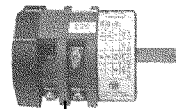

**93.058**  
INTERRUPTEUR  
20A 0-1

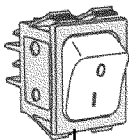

**93.003**  
INTER. BIPOLAIRE  
0-1 ROUGE

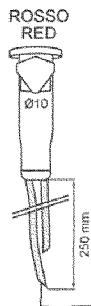

220V

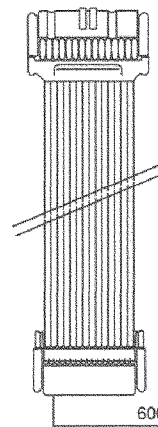

600 mm - 16 PIN  
800 mm - 16 PIN